

### 灌阳县

- 规划用地面积: 9201.18m<sup>2</sup>
- 容积率: ≤0.5
- 建筑密度: ≤30%
- 建筑限高: ≤18m
- 专业队伍营房面积: ≤1800m<sup>2</sup>
- 专业队伍车库面积: ≤300m<sup>2</sup>

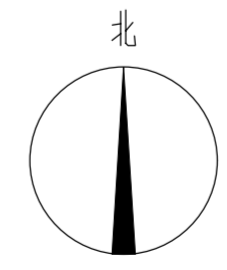

# 灵川县

规划用地面积: 18451.43m<sup>2</sup>  
保留办公用地面积: 8651.95m<sup>2</sup>  
净用地面积: 9799.48m<sup>2</sup>  
容积率: ≤0.5  
建筑密度: ≤30%  
建筑限高: ≤18m  
专业队伍营房面积: ≤2000m<sup>2</sup>  
专业队伍车库面积: ≤300m<sup>2</sup>

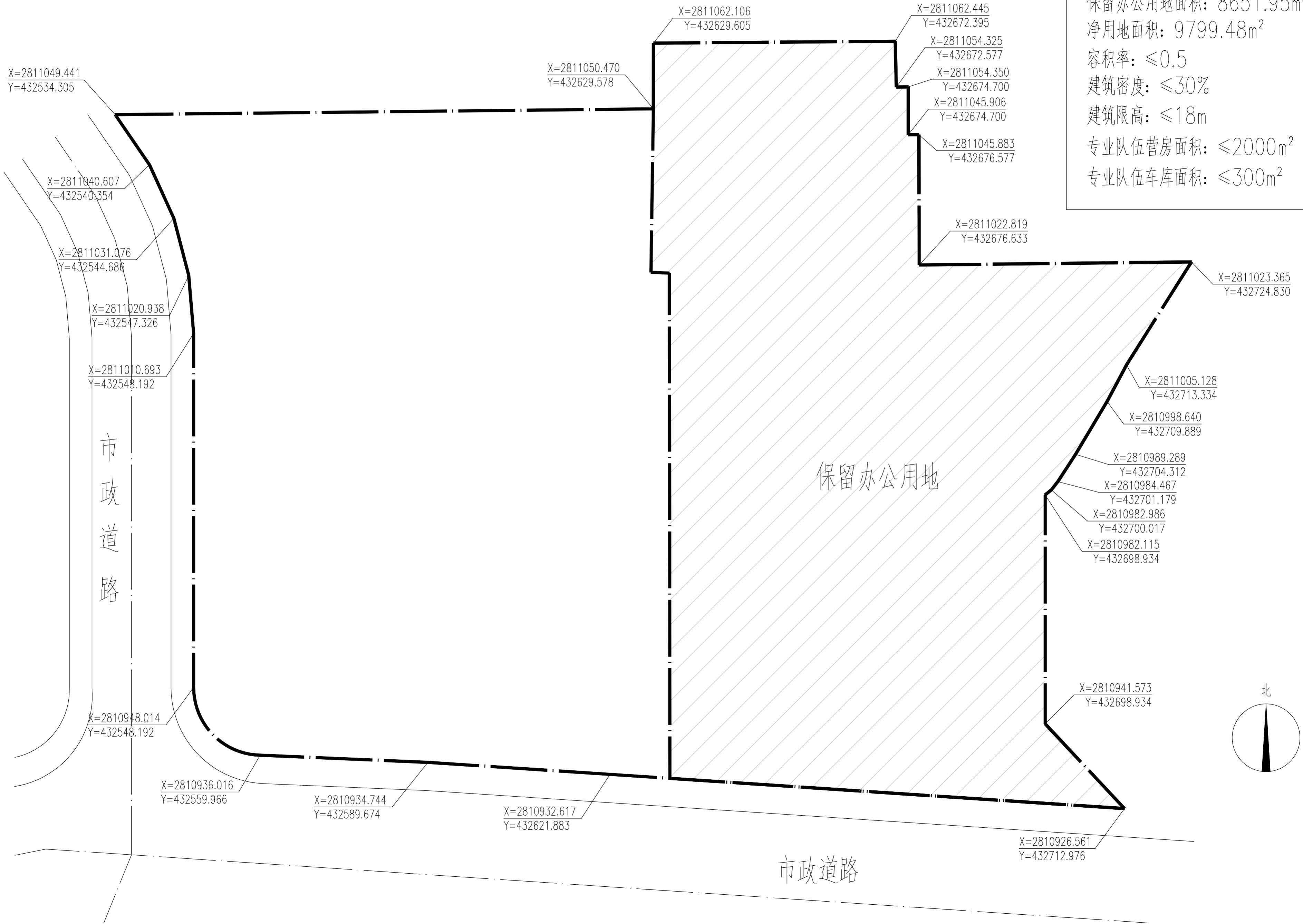

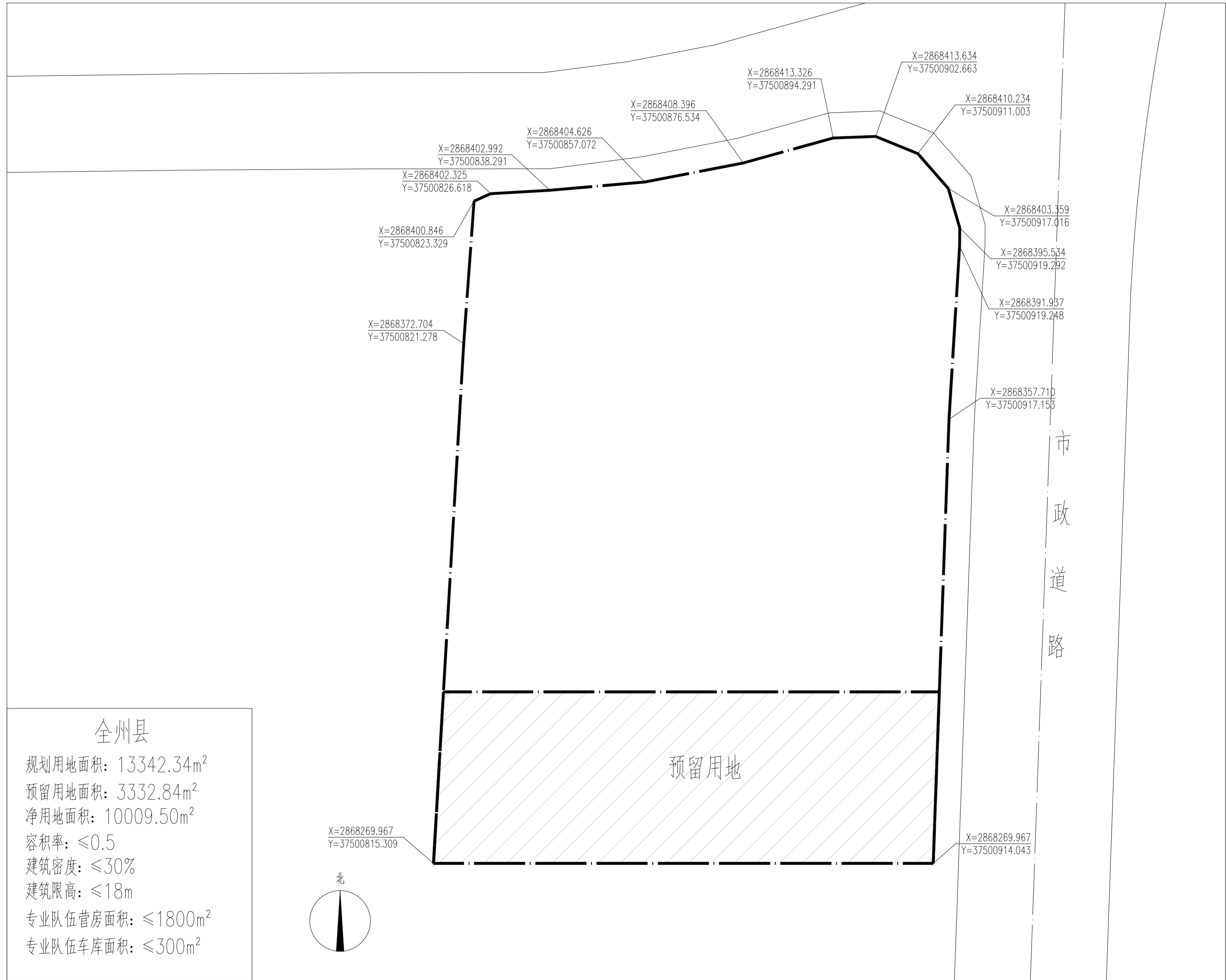

X=2868413.326  
Y=37500894.291  
 X=2868408.396  
Y=37500876.534  
 X=2868413.634  
Y=37500902.663  
 X=2868410.234  
Y=37500911.003  
 X=2868404.626  
Y=37500857.072  
 X=2868402.992  
Y=37500838.291  
 X=2868402.325  
Y=37500826.618  
 X=2868400.846  
Y=37500823.329  
 X=2868372.704  
Y=37500821.278  
 X=2868403.359  
Y=37500917.016  
 X=2868395.534  
Y=37500919.292  
 X=2868391.937  
Y=37500919.248  
 X=2868357.710  
Y=37500917.153

市政道路

预留用地

X=2868269.967  
Y=37500815.309

X=2868269.967  
Y=37500914.043

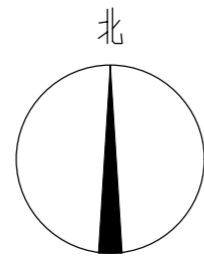

全州县

- 规划用地面积: 13342.34m<sup>2</sup>
- 预留用地面积: 3332.84m<sup>2</sup>
- 净用地面积: 10009.50m<sup>2</sup>
- 容积率: ≤0.5
- 建筑密度: ≤30%
- 建筑限高: ≤18m
- 专业队伍营房面积: ≤1800m<sup>2</sup>
- 专业队伍车库面积: ≤300m<sup>2</sup>

